



Village of Itasca
Community Development Department
550 W. Irving Park Rd. Itasca, IL 60143
Phone: 630/773-5568 Fax: 630/773-0852
www.itasca.com

FENCES

SPECIFICATIONS

FENCE CONSTRUCTION

- Fence permits: a fence permit is required for the construction of all fences. Provide the Building Department with a copy of the Plat of Survey showing the proposed location of the fence and cut sheets or drawings of the proposed fence detailing fence heights, materials, and fence design.

LOCATION

- All fences shall be properly constructed on the fence owner's property.
- All fences shall be permanent except for garden fences enclosing a garden in a rear yard or side yard not exceeding three (3) feet in height.
- Except as follows, all permitted fences shall be constructed within one (1) foot of the fence owner's side or rear lot lines:
 - Except where the permitted fence returns to the existing building or structure to enclose a yard.
 - Except for patio privacy fences (screens not exceeding six (6) feet in height within the buildable area of the lot;
 - Dog enclosures or runs not exceeding five (5) feet in height or enclosing greater than twenty (20) percent of the rear yard, constructed in the rear yard or buildable lot area and set back not less than five (5) feet from all property lines.

FENCE INSTALATION

- All fences shall be installed so that the finished side faces out. All structural supports, if exposed, shall be located in such a manner so as to face the principal building on the lot on which the fence is located. Fence post holes to be 42" in depth.

FENCE HEIGHTS

- Solid fences four (4) feet high plus one (1) foot high 50% open fence top for a five (5) foot high fence.
- Solid fences which served to screen or hide business or manufacturing activities over four (4) feet in height when recommended by the Plan Commission and approved by the Village Board.
- Any fence on a corner lot which extends closer to the adjoining street than the front yard or side yard setbacks lines (see Illustration Item "B"), except for open decorative fence or landscaping under three (3) feet high is allowed.
- Open fences – six (6) feet high.
- A solid patio screening fence may be erected to a height measured from grade not to exceed six (6) and a total length not to exceed thirty-six (36) lineal feet provided that in no case shall any portion of the screen be placed in a required front or corner side yard so or so to impair the visibility of the entire area of a swimming pool from the principal dwelling on the premises.

SUBMITALS

- Completed permit application/ four (4) sets of Plat of Survey and fence cut sheet of fence detail drawing.

REQUIRED INSPECTIONS

Post hole
Final

ILLUSTRATIONS

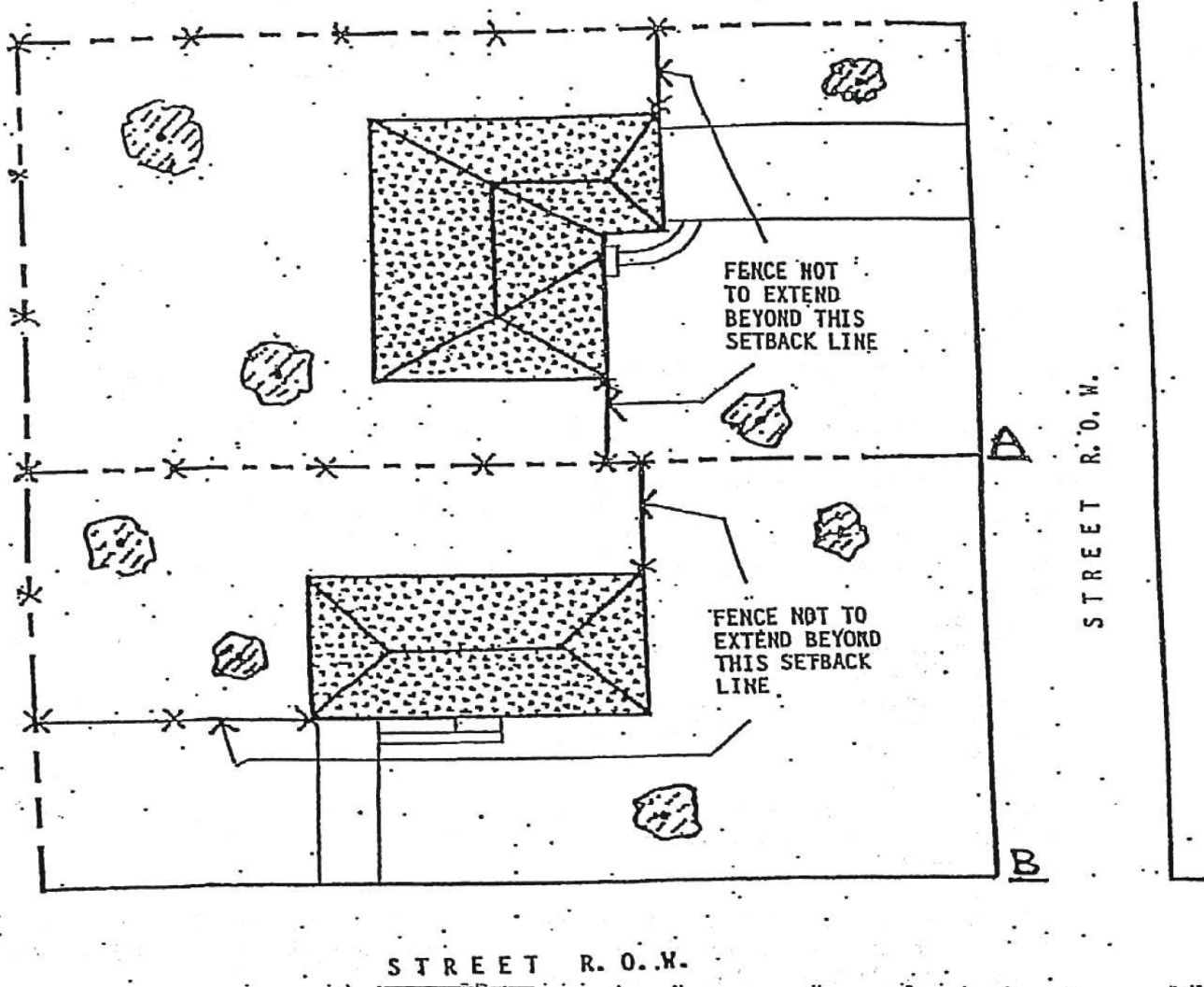

No Scale

FENCE LOCATION

See Zoning Ordinance Section 4.20 Fences.